

## SINGLE HUNG INSTALLATION & REMOVAL GUIDE

*Begin by opening the window to expose the window screen track.*

### INSTALLATION

#### STEP 1

*Raise and tilt the lower sash inward.*

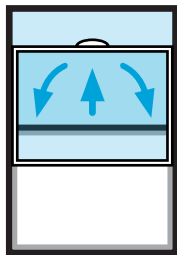

#### STEP 2

*The screen will drop into the opening from the top down. Make sure screen is seated properly in the window screen track.*

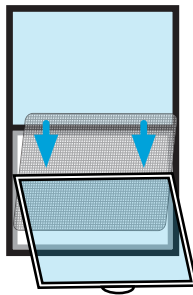

#### STEP 3

*Insert the open edge of the retention clip into the groove near the edge of the window opening.*

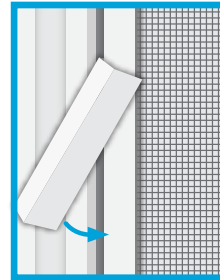

#### STEP 4

*With the retention clips installed, slide the clips to the top of the window screen.*

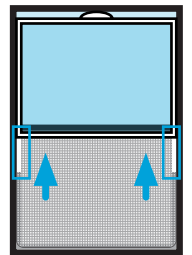

### REMOVAL

#### STEP 1

*Slide the two screen retention clips to the middle of the window screen.*

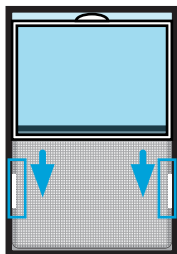

#### STEP 2

*Using a flathead screwdriver, insert the end of the screwdriver into the open end of the clip and pry the clip off.*

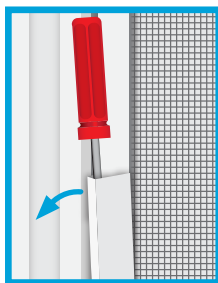

#### STEP 3

*Raise and tilt the Lower sash inward.*

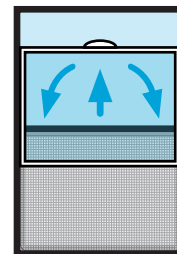

#### STEP 4

*Pull the screen up and out from the top opening.*

